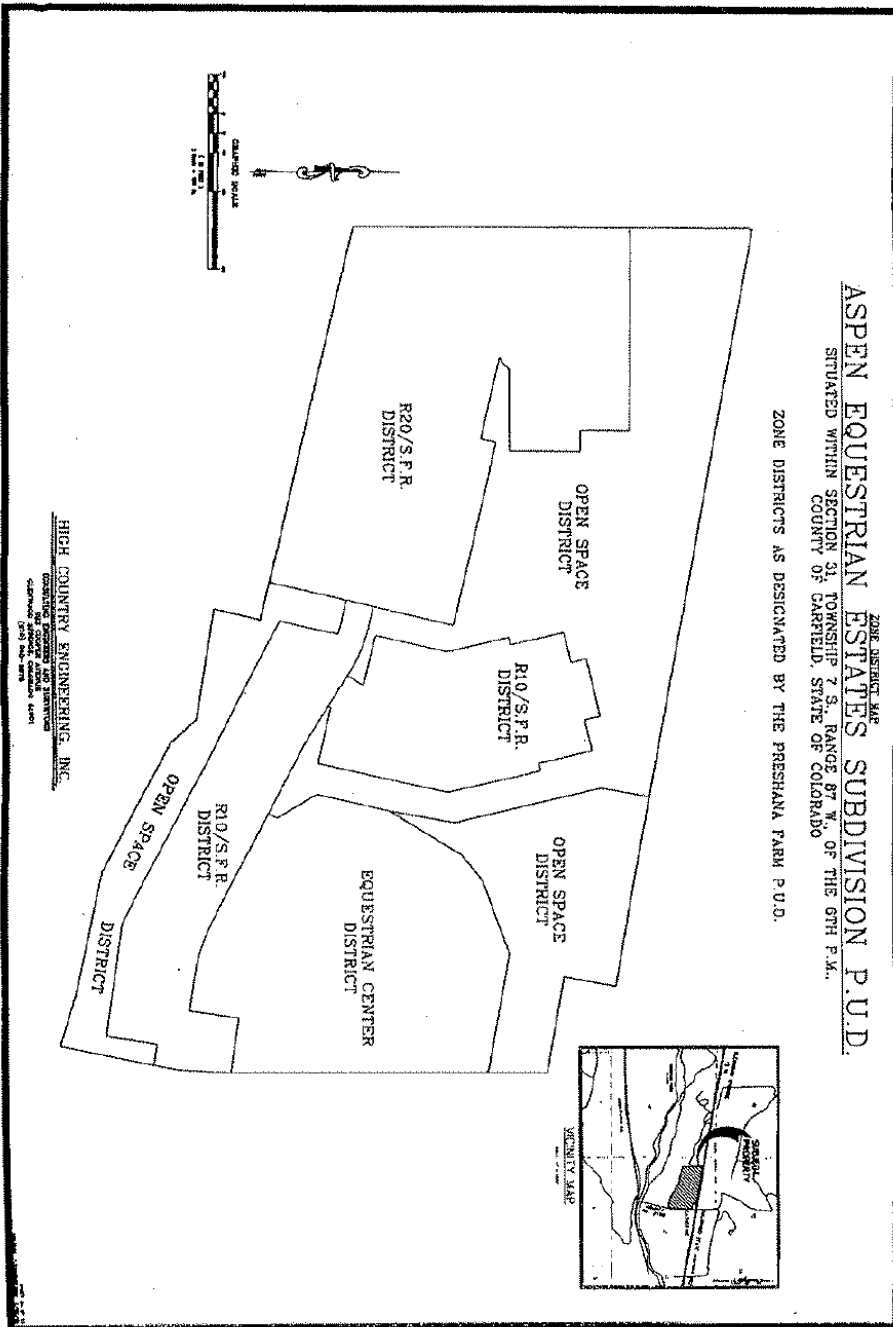

Exhibit B

599691 02/24/2000 01:39P B1174 P197 M ALS DORF  
12 of 12 R 0.00 D 0.00 GARFIELD COUNTY CO



**ZONE DISTRICT MAP**  
**ASPEN EQUESTRIAN ESTATES SUBDIVISION P.U.D.**  
 SITUATED WITHIN SECTION 31, TOWNSHIP 7 S., RANGE 87 W., OF THE 6TH P.M.,  
 COUNTY OF GARFIELD, STATE OF COLORADO

ZONE DISTRICTS AS DESIGNATED BY THE PRESHANA FARM P.U.D.